

4' Extension Handle Kit for Heavy-Duty Aquatic Weed Rake Assembly Instructions

3005.4381

Item	Part Number	Description	Qty
1	4381-001	4' Extension Tube	1
2	4381-100	8" Splice Tube	1

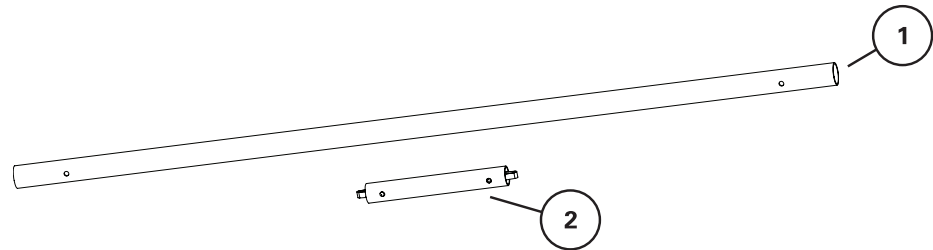

Product Satisfaction Guarantee

At Extreme Max, we pride ourselves on making quality products and wish to correct any mistakes on our end. If you are not 100% satisfied with the product, for any reason, please reach out to us. We are here to help!

Warranty

This product is warranted for consumer use for 2 years after the date of retail purchase. Warranty includes parts only. Warranty valid only in the USA.

This product is warranted to the original retail purchaser to be free from defects in material and workmanship, ordinary wear and tear expected. This warranty shall not apply to any defects caused by: (I) overloading, (II) physical abuse of goods or any acts of vandalism by any person, (III) improper installation or use contrary to the instructions, (IV) commercial use. The sole remedy under this warranty is at the discretion of manufacturer: the replacement of the same or similar product, or the refund of the original purchase price. Extreme Max™ is not responsible for any consequential or incidental damages. Any and all freight charges to handle warranty claims are the responsibility of the consumer. Extreme Max™ is not responsible for any labor charges that may be incurred.

For all inquiries please send your name, mailing address, main contact phone number, original retail sales receipt, summary of alleged defect and any applicable pictures to service@extrememax.com.

Installation Instructions

Read all information included on this page before beginning operation or installation.

1. On the assembled Heavy-Duty Aquatic Weed Rake handle, use the push-pins to separate the upper handle from the lower handle.
2. Insert the 8" splice tube into the lower handle and maneuver so the handle lock pins snap into position inside the lower handle's button holes.
3. Place the 4' extension tube onto the open end of the splice tube and maneuver so the handle lock pins snap into position inside the extension tube's button holes.
4. Insert the upper handle into the open end of the extension tube and maneuver so the upper handle lock pins snap into position inside the extension tube's button holes. (Position the upper handle so the angled end points the same direction as the tines.)

3005.4381

Item	Part Number	Description	Qty
1	4381-001	4' Extension Tube	1
2	4381-100	8" Splice Tube	1

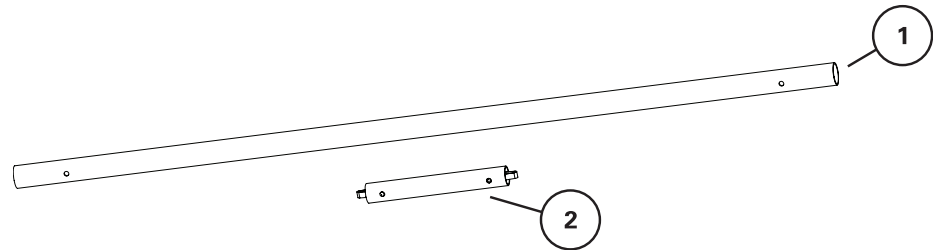

Product Satisfaction Guarantee

At Extreme Max, we pride ourselves on making quality products and wish to correct any mistakes on our end. If you are not 100% satisfied with the product, for any reason, please reach out to us. We are here to help!

Warranty

This product is warranted for consumer use for 2 years after the date of retail purchase. Warranty includes parts only. Warranty valid only in the USA.

This product is warranted to the original retail purchaser to be free from defects in material and workmanship, ordinary wear and tear expected. This warranty shall not apply to any defects caused by: (I) overloading, (II) physical abuse of goods or any acts of vandalism by any person, (III) improper installation or use contrary to the instructions, (IV) commercial use. The sole remedy under this warranty is at the discretion of manufacturer: the replacement of the same or similar product, or the refund of the original purchase price. Extreme Max™ is not responsible for any consequential or incidental damages. Any and all freight charges to handle warranty claims are the responsibility of the consumer. Extreme Max™ is not responsible for any labor charges that may be incurred.

For all inquiries please send your name, mailing address, main contact phone number, original retail sales receipt, summary of alleged defect and any applicable pictures to service@extrememax.com.

Installation Instructions

Read all information included on this page before beginning operation or installation.

1. On the assembled Heavy-Duty Aquatic Weed Rake handle, use the push-pins to separate the upper handle from the lower handle.
2. Insert the 8" splice tube into the lower handle and maneuver so the handle lock pins snap into position inside the lower handle's button holes.
3. Place the 4' extension tube onto the open end of the splice tube and maneuver so the handle lock pins snap into position inside the extension tube's button holes.
4. Insert the upper handle into the open end of the extension tube and maneuver so the upper handle lock pins snap into position inside the extension tube's button holes. (Position the upper handle so the angled end points the same direction as the tines.)