

## IMPORTANT INFORMATION

Before installation, read and understand all instructions and warnings.

For installation, refer to installation instructions. Installation requires lift-specific installation kit.

All 120 Volt units MUST have electrical ground fault interrupter protection.

### **Important**

- Read all instructions and warnings prior to installation and use.
- For use by adults over age 18.
- Wait for the motor to come to a complete stop before changing directions.
- Do not lift anything other than your boat.
- Put one of the two keys on a floating key chain and the spare key in a safe place.
- Original Generation 5 units contained a red connector to connect the electronics box to the motor. A replacement gray connector will be included with all replacement units.



### **Warning:**

- Hazardous voltage. Contact may cause electrical shock and injury. Disconnect before servicing.
- Misuse of this product can result in bodily injury, death, or property damage.
- Do not overload the capacity of the lift or drive system. When lifting, do not let the cradle or pulleys make contact with the lift frame. Serious injury or damage could occur.
- When lowering the lift, go down just far enough so the boat will come off of the lift. Running the system too long in the down cycle will wind the cable backwards and lift the boat, which could cause serious injury or damage.
- To prevent serious personal injuries or death, do not allow children, swimmers or pets on or near the boat lift while it is in operation as they may become caught under the boat and suffer pinch, amputation or other serious injuries.
- In the event of unintentional or erratic operation permanently unplug unit from power source to disable the system and contact the Extreme Max service department at 651-357-1862.
- **120 Volt Boat Lift Boss:**
  - 120 Volt models must only be used on an electrical current equipped with a Ground Fault Circuit Interrupter (GFCI).
  - Supply circuits must be installed to all applicable electrical codes.
  - All necessary electrical work should be completed by a licensed electrician.
  - Boat Lift Boss unit must be connected to the power source using a marine-rated, 3-prong grounded cord. The cord should be regularly inspected to ensure a good working condition.
  - Improper wiring or lack of a properly installed Ground Fault Circuit Interrupter (GFCI) poses a high risk of injury or death.
- **12/24 Volt Boat Lift Boss:**
  - 12/24 Volt models should be paired with marine-grade, deep cycle batteries. Common sizes include Group 24 and Group 27 batteries.
  - Never connect the longer lead (Red) to the motor lead (Gray). The longer lead always goes to the battery.



### **Caution:**

The recessed pigtail connector at the bottom of the Boat Lift Boss Unit allows for a pendant controller option to be added at any time. Do not tamper with or remove the protective cap unless you are adding the pendant controller option.

- To order a pendant controller, contact Boat Lift Boss or your local stocking dealer.

### **120 Volt Boat Lift Boss:**

- If the unit is to be left unattended, disconnect the unit from the power source to prevent damage from lightning and electrical surges.

### **12/24 Volt Boat Lift Boss:**

- If the unit is to be left unattended, disconnect the unit from the power source or press the Power button to the "Off" setting to prevent damage. The Power button light is off when the unit does not have power.

- Remote Control Models - Wireless and Handheld – (If applicable)
- Do not attempt to use the key switch and the remote control at the same time.
- Prevent property damage by removing the key from the control box before using the remote control.



## Contents:

Qty.	Description
1	- Boat Lift Boss™
2	- Keys
1	- Wire harness with battery ring terminal connectors (12 volt models only)
1	- Wireless remote (Remote control models only)

## Maintenance

Inspect Boat Lift Boss™ and electrical connections regularly to insure that all parts are in good working condition, with no signs of corrosion or frayed wires.

## Storage

Boat Lift Boss units do not require covering during storage. However, if you are to cover your unit, cover only with breathable, well-ventilated material. Do not wrap the unit tightly with plastic or other non-breathable, non-ventilated material.

## Back-Up Drive

During power outage, use a cordless drill with a 1/4" extension and a 7/16" or 1/2" socket on the bottom of the motor shaft. Counter-clockwise lifts boat and clockwise lowers the boat.

## Removal from Winch Box

1. Completely lower the lift rack so there is no tension on the winch cable.
2. Remove the hardware securing the teardrop bracket to the winch box installation bracket.
3. Remove the black rubber cap from the face of the Boat Lift Boss™ unit.
4. Remove the 5/16" bolt from the hole opening.
5. Carefully pull the Boat Lit Boss™ unit away form the winch box until it separates from the drive stub. Be careful to not lose the 8mm key from the drive stub keyway slot.
6. Remove the drive stub from the winch box input shaft.

## Field Upgrade / Field Serviceability

Boat Lift Boss™ Direct Drive units feature a field-serviceable housing that provides an easy way to upgrade your model and/or service the electrical box without needing to lower your lift.

### Open Unit

1. Locate and remove all Phillips head screws surrounding the front of the unit.
2. Slowly separate the front half of the housing from the rear half.
3. Once open:
  - 12/24 Volt: Locate the gray quick-connect connector between the two halves. Separate the connectors.
    - o Note: Original Generation 5 units contained a red connector to connect the electronics box to the motor. A replacement gray connector will be included with all replacement units.
  - 120 Volt: Locate the three quick-connect connectors between the two halves. Separate all three connectors.

### Close Unit

1. Place the front housing near the mounted rear housing.
2. Locate the gray quick-connect connectors within the rear housing and connect it to the gray quick-connect connector in the front housing.
  - IMPORTANT: Never connect the longer lead (Red) to the motor lead (Gray). The longer lead always goes to the battery.
3. Align the front housing with the rear housing so their edges sit flush.
4. Place the Phillips head screws through the front housing and into the rear housing. Tighten until snug. Do not over-tighten.

## 12/24 Volt Models

12/24 Volt units are equipped with a Power Save button. To activate the unit, press and hold the button until the power light turns on. At the end of the operation, press and hold the Power Save button until the light turns off.

### 24 Volt Operation

Using 24-volt power can nearly double your pulling speed. Wire the batteries in series according to the following instructions and the diagram to the right.

**Warning:** Electric arc flash hazard. Improperly connected terminals may result in explosion or electric shock. Follow all instructions for wiring in series. Always connect to positive (+) terminal before negative (-) terminal.

- 1) Attach the jumper wire to the positive (+) terminal of one battery, then the negative (-) terminal of the other.
- 2) Attach the Boat Lift Boss™ positive (+) power lead to the remaining positive (+) battery terminal.
- 3) Attach the Boat Lift Boss™ negative (-) power lead to the remaining negative (-) battery terminal.

**Note:** Use Extreme Max Boat Lift Boss Connect-Ease Wiring Harness (sold separately - 3005.7249).

### 24 Volt Wiring Diagram

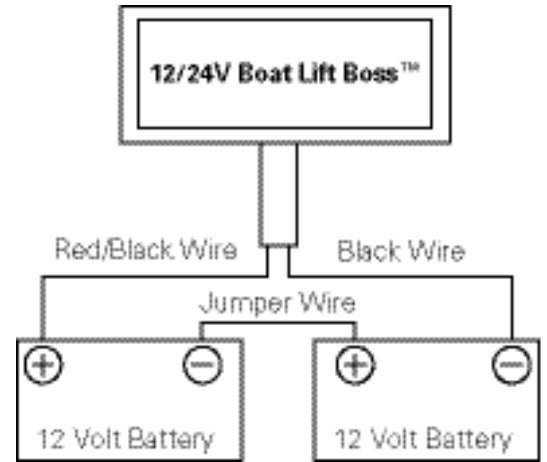

Red/Black Wire: Positive +  
Black Wire: Negative -

### Remote Control Models (Wireless)

- Remote Range will vary depending upon land topography and ground clutter (trees, buildings, etc.).
- Do not use remote more than 15 feet (4.5m) from the lift. This will prevent accidentally exceeding the travel limits of the boat lift. Never operate the remote out of visual contact.
- Allow the motor to come to a complete stop before changing directions.

**Note:** The motor may remain in motion for up to three seconds before coming to a complete stop after releasing the button.

Loop the electrical cord connection as shown to help secure connection.

Fig. 1



Fig. 2

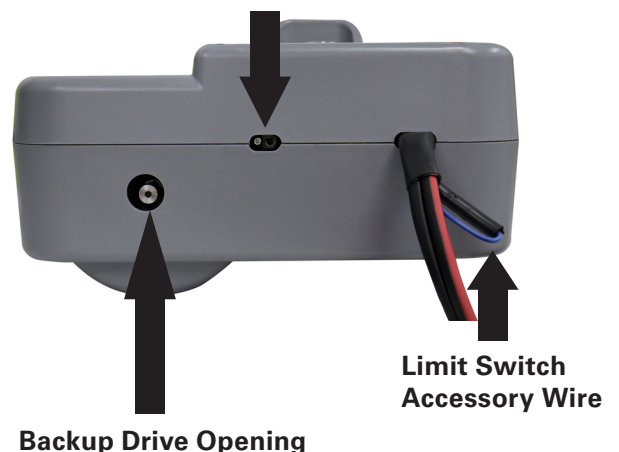

# Boat Lift Boss™ Electronics Module Procedures

## Warnings:

- **Disconnect the Boat Lift Boss unit from the power source before attempting any servicing or maintenance of the unit.**

## Field-Upgradable Electronics Module

Your Boat Lift Boss unit is equipped with a field upgradable electronics module, allowing the unit to be easily upgraded or have the electronics serviced.

## Removing the Electronics Module:

Prior to removing the electronics module, email [service@extrememax.com](mailto:service@extrememax.com) to obtain the proper paperwork for the upgrade or service needed. In addition, disconnect the Boat Lift Boss unit from the power source. As the motor will remain in place during the electronics module removal, there is no need to reposition the lift or remove the boat at this time.

1. **Disconnect the Boat Lift Boss unit from the power source before attempting any servicing or maintenance of the unit.**
2. Locate and remove the screws on the front face of the Boat Lift Boss housing using a #1 Phillips-head hand screw driver. Do not use power tools to remove the screws.



3. Separate the front housing piece from the rear housing, being careful not to dislodge the still-connected internal wiring.

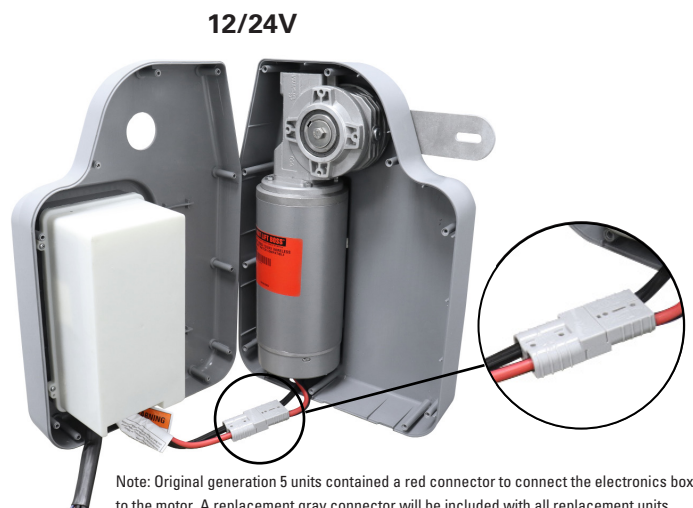
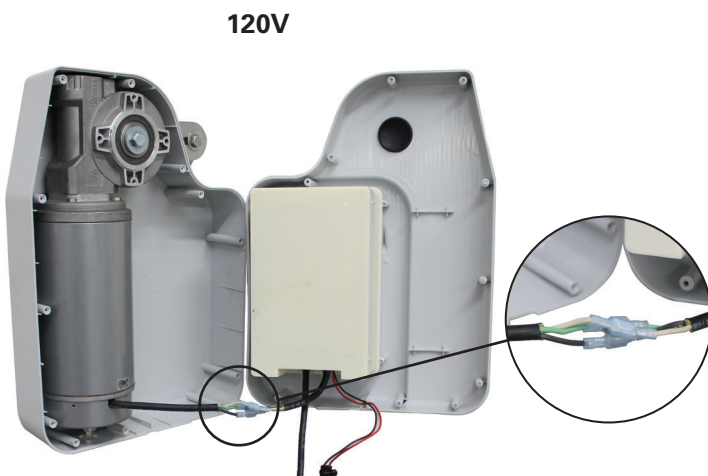

Note: Original generation 5 units contained a red connector to connect the electronics box to the motor. A replacement gray connector will be included with all replacement units.



4. Disconnect the quick-connect wiring connectors to remove the electronics module and front housing from the remainder of the Boat Lift Boss unit. Do not separate the electronics module from the front housing.

120V

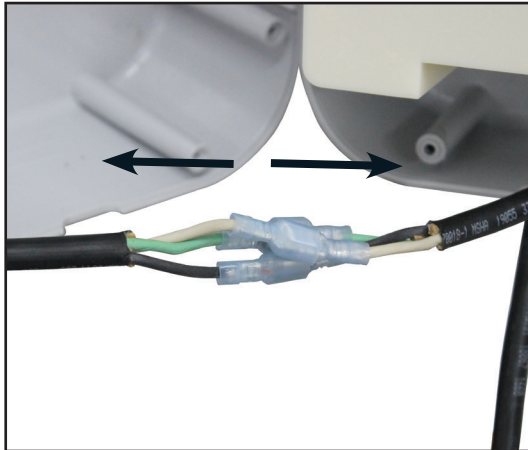

12/24V

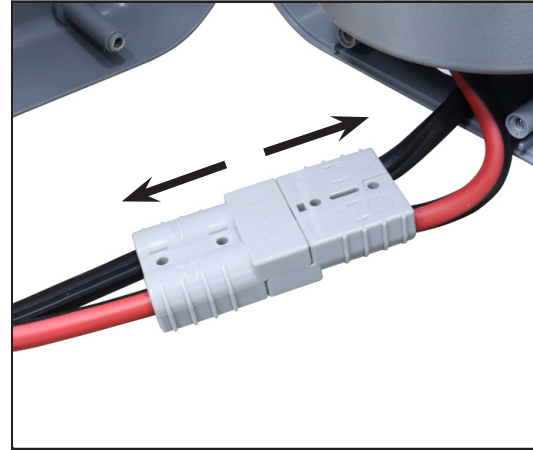

120V

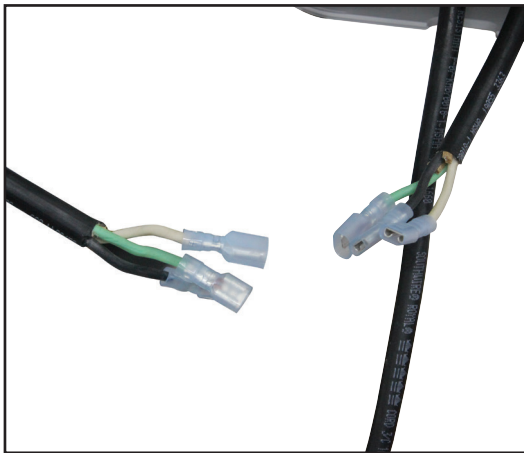

12/24V



120V



Back side of the unit stays on the lift

Front side unit is sent to Extreme Max

12/24V

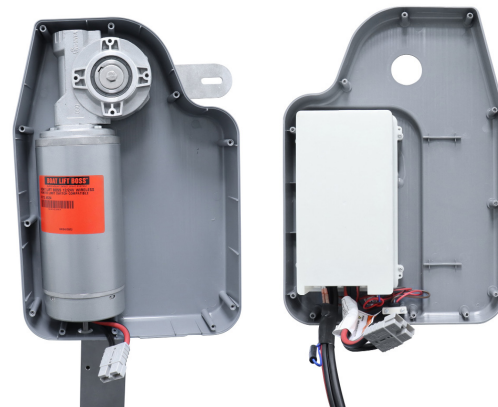

Back side of the unit stays on the lift

Front side unit is sent to Extreme Max

To reinstall the electronics module, reverse steps 1-4. Evenly hand tighten the housing screws only. Do not use power tools.

**IMPORTANT:** Never connect the longer lead (Red) to the motor lead (Gray). The longer lead always goes to the battery. If connectors are attached incorrectly, major damage will occur.

# Boat Lift Boss™ Connector Guide/Video Demo

Boat Lift Boss replacement field-serviceable housing units now come with a Red and Gray connector that will need to be attached to the bare leads extending from the electronics module inside the unit's front cover. Attach the connector that color-matches the connector on the pigtail extending from the unit's motor.

When inserting the wire pins in the plastic connector, pay close attention to the orientation of the pins and connector. Make sure the letters "SC6" are facing upward on the wire pins and the + and - are facing upward on the connector. Insert the wire pins into the back of the connector with the red pin on the positive (+) side and the black pin on the negative (-) side. Insert each pin until you here a click, then pull gently on the wire to ensure the pin is securely inserted into the connector.



Connect Positive



Connect Negative

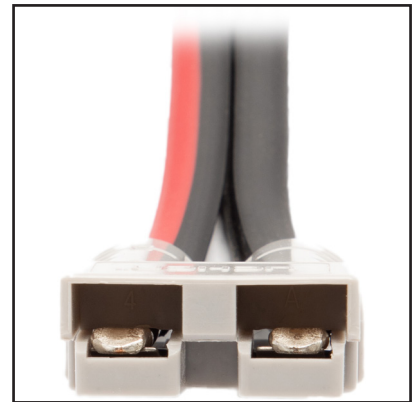

Verify Connection

Use your mobile device to scan the QR code on the right to view a video demonstration on the quick connector installation process. Watch each step of the video carefully as the method of attaching the quick connector to the bare leads is crucial to a safe and successful installation.

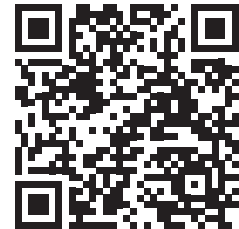

If you are having trouble using the QR code, visit the Extreme Max YouTube channel for access to the tutorial.

Original Generation 5 units contained a red connector to connect the electronics box to the motor. A replacement red and gray connector will be included with all replacement units so that you can match your motor lead.

**IMPORTANT:** Never connect the longer lead (Red) to the motor lead (Gray). The longer lead always goes to the battery. If connectors are attached incorrectly, **major damage will occur.**

Original Red Connector

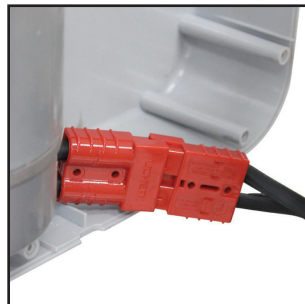

Updated Gray Connector

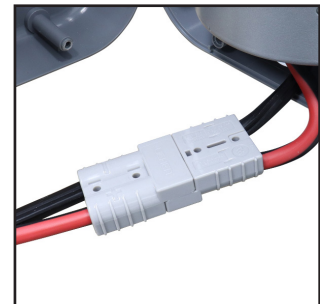

# If there are any missing or damaged parts, DO NOT return Boat Lift Boss™ to the retailer.

Call the Boat Lift Boss™ Service Dept. at (651) 357-1862  
E-mail - boatliftboss@extrememax.com

## Limited Warranty

Extreme Max™ Boat Lift Boss™ Direct Drive Systems are conditionally warranted for consumer use for 2 years after the date of retail purchase. Warranty valid only in the USA and Canada.

Extreme Max™ Boat Lift Boss™ Direct Drive Systems are conditionally warranted to the original retail purchaser to be free from defects in material and workmanship, ordinary wear and tear expected. This warranty shall not apply to any defects caused by (I) overloading, (II) physical abuse of goods or any acts of vandalism by any person, (III) improper installation or use contrary to the instructions, (IV) commercial use, (V) saltwater use. The sole remedy under this warranty is at the discretion of the manufacturer: the repair of the product by the manufacturer at the manufacturer's facility, or the replacement of the same or similar product. Extreme Max™ is not responsible for any consequential or incidental damages. The consumer shall be responsible for shipping charges to return any unit believed to be defective to Extreme Max™. Repaired or replacement units shall be returned to the consumer at the manufacturer's expense. Any and all expedited freight charges to handle warranty claims are the responsibility of the consumer. Extreme Max™ is not responsible for any 3rd party labor charges that may be incurred in removing, transporting or installing the lift.

Extreme Max™ disclaims any other express warranties, all UCC implied warranties, and warranties of merchantability and fitness for purpose.

To expedite warranty service, please complete and return the Warranty Registration Card along with a copy of original retail sales receipt at the time of purchase.

To submit a warranty claim, please send your name, mailing address, original sales receipt and summary of alleged defect to boatliftboss@extrememax.com. Please e-mail or call (651) 357-1862 with questions regarding warranty service and claims.

3015.3624



158380