

Winch Mount for Polaris Ranger XP 900/570 Installation/Operating Instructions

Item	Part No.	Description	Qty
1	3282-100	Winch Mount	1
2	3256-003	Fairlead Adapter Plate	1
3	3282-002	Grille Plate	1
4	91287A556	M10 x 1.5 x 25mm Hex Head Bolt	2
5	92148A210	M10 Split Washer	2
6	94710A104	M8 x 1.25 Flanged Lock Nut	1
7	94710A105	M8 x 1.25 Flanged Lock Nut	2
8	97248A326	M10 x 1.5 x 25mm Carriage Bolt	2
9	97248A326	M8 x 1.25 x 25mm Flanged Bolt	3

5600.3282

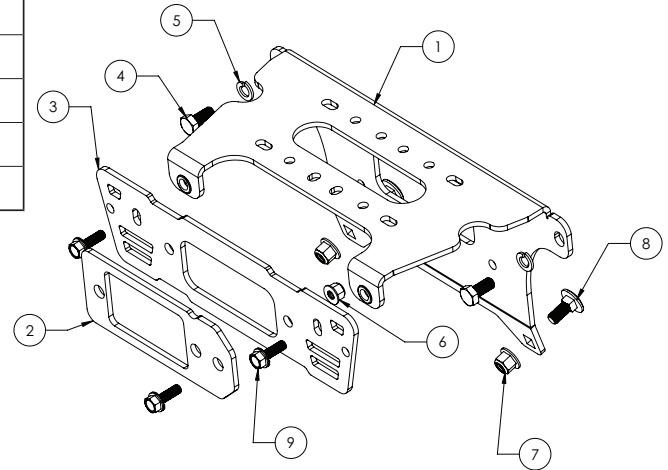

Required Tools - Not Included

1. Winch
2. Roller Fairlead

Read, Follow, and Save These Instructions.

Prior to Installation:

1. Turn off vehicle and lock the brakes.
2. Locate the battery compartment. Remove the ground terminal, then the positive terminal to disconnect the battery cables.

Warnings:

Risk of personal injury or property damage. An improperly mounted winch may result in a sudden release of the winch mount and/or winch from the UTV frame. Follow all winch manufacturer's instructions for proper mounting and use of your winch.

Product Satisfaction Guarantee

At Extreme Max, we pride ourselves on making quality products and wish to correct any mistakes on our end. If you are not 100% satisfied with the product, for any reason, please reach out to us. We are here to help!

Warranty

This product is warranted for consumer use for 2 years after the date of retail purchase. Warranty includes parts only. Warranty valid only in the USA.

This product is warranted to the original retail purchaser to be free from defects in material and workmanship, ordinary wear and tear expected. This warranty shall not apply to any defects caused by: (I) overloading, (II) physical abuse of goods or any acts of vandalism by any person, (III) improper installation or use contrary to the instructions, (IV) commercial use. The sole remedy under this warranty is at the discretion of manufacturer: the replacement of the same or similar product, or the refund of the original purchase price. Extreme Max™ is not responsible for any consequential or incidental damages. Any and all freight charges to handle warranty claims are the responsibility of the consumer. Extreme Max™ is not responsible for any labor charges that may be incurred.

For all inquiries please send your name, mailing address, main contact phone number, original retail sales receipt, summary of alleged defect and any applicable pictures to service@extrememax.com.

Installation Instructions

Read all information included on page 1 before beginning operation or installation.

1. Remove the bumper from the UTV. There are two bolts to be removed at the bottom of the bumper and two bolts at the top of the bumper, one each behind the bumper's upright on either side of the grille.
2. Use a Torx wrench to remove the two screws at the front of the bumper securing the plastic grille.
3. Loosely secure the grille plate to the bumper using the Torx screws removed in Step 2.
4. Attach the roller fairlead to the grille and bumper assembly using the hardware included with the fairlead. Standard fairleads will not require the use of the fairlead adapter plate, however smaller fairleads will. If required, install the fairlead adapter plate to the grille before installing the fairlead.
5. Before installing the winch, be aware that winches with vertically oriented leads must be repositioned before installation. Loosen the cap screws to rotate the cap and reposition the leads into a 45° alignment or horizontal alignment.

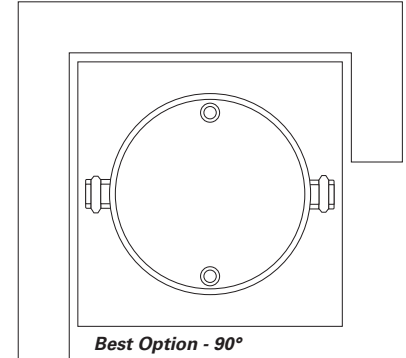
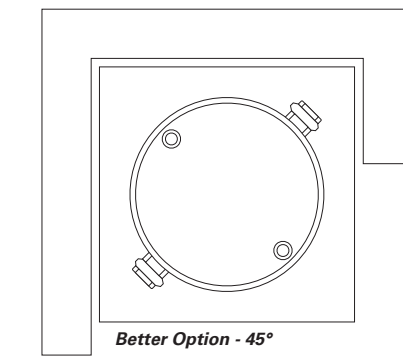
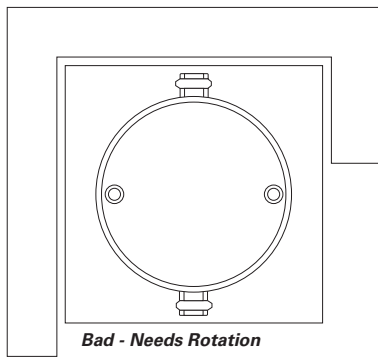

Figure 1

Figure 2

Figure 3

6. Install the winch to the winch plate. There are three different configurations for mounting the winch shown below. Use these diagrams to determine the proper mounting position based on your winch's mounting pattern.

- Two-Hole Bolt Pattern (3.100") (Fig. 4)
- Standard Bolt Pattern (3.00" x 4.875") (Fig. 5)
- Wide Bolt Pattern (3.00" x 6.60") (Fig. 6)

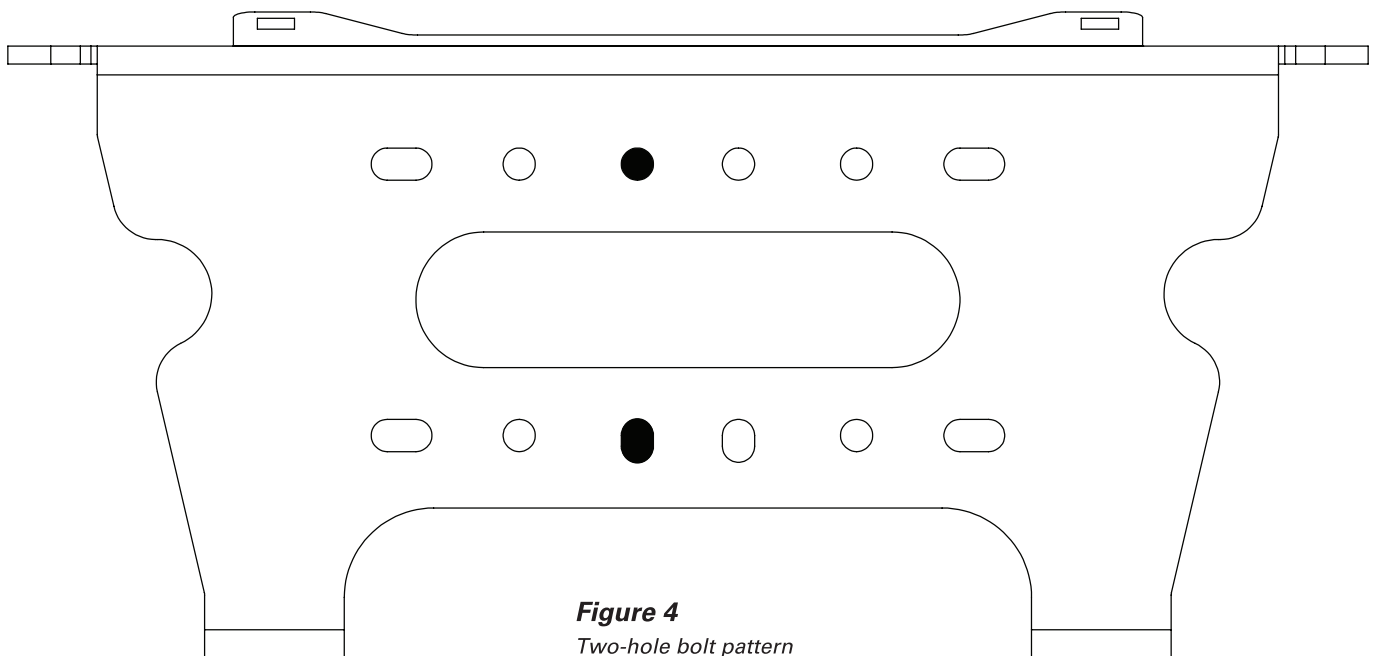

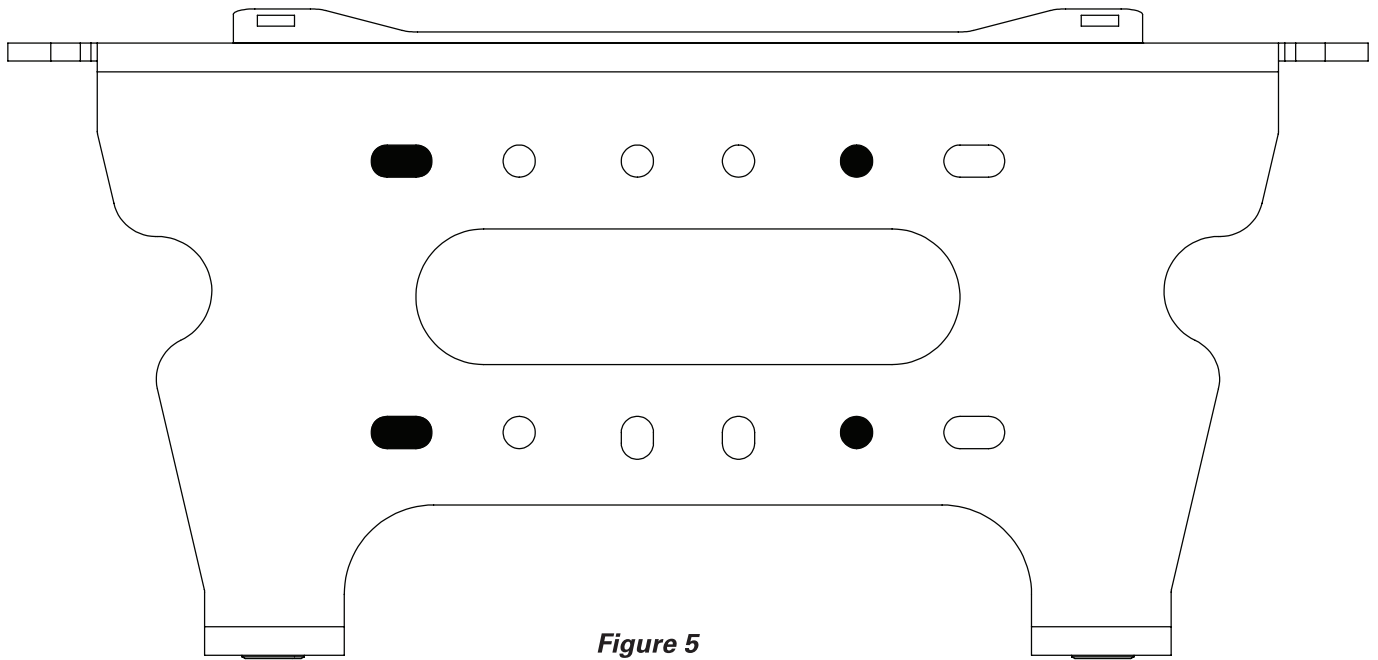

Figure 5
Standard bolt pattern

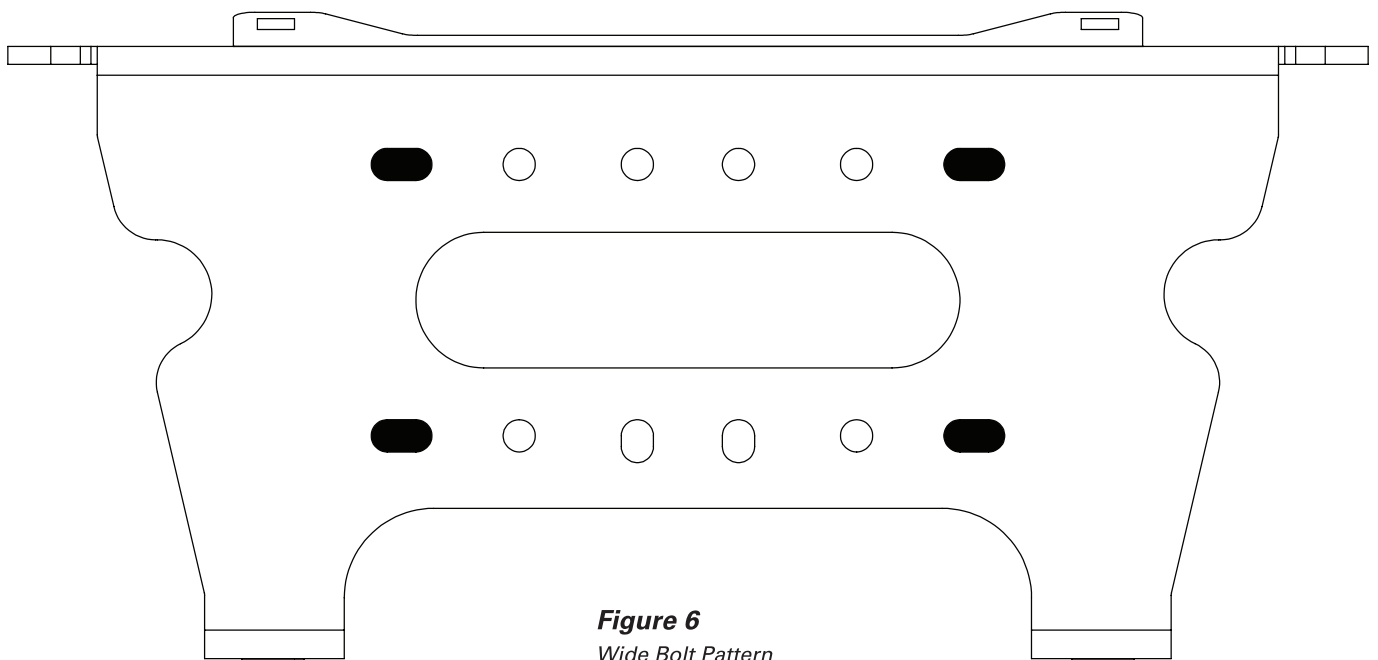

Figure 6
Wide Bolt Pattern

7. Place the winch mount assembly along the front of the UTV just underneath the radiator opening. Align the four mounting holes with the four matching holes in the UTV frame. Fasten the winch mount assembly to the frame using an M8 x 1.5 x 25mm hex head bolt secured by an M8 lock nut through each of the top two aligned holes. Pass the M10 x 1.5 x 25mm carriage bolts through the UTV frame then through the winch mount's bottom mounting holes. Secure each carriage bolt with an M10 lock nut.
8. Reinstall the front bumper using its original hardware.
9. Follow the winch manufacturer's recommendations for proper winch wiring procedures.