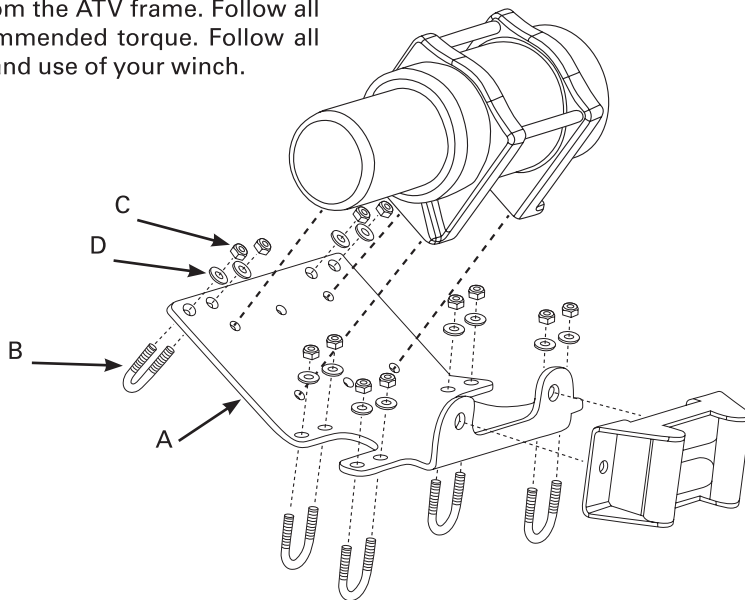

**Part # 5600.3136
Style # 545001****⚠ Warning:**

Risk of personal injury or property damage. An improperly mounted winch may result in a sudden release of the winch mount and/or winch from the ATV frame. Follow all instructions and install and maintain hardware at recommended torque. Follow all winch manufacturer's instructions for proper mounting and use of your winch.

Includes:

- (1) Winch Mount (A)
- (6) M6-1.0 x 38mm U-Bolts (B)
- (12) M6-1.0 Nylock Nuts (C)
- (12) M6 Flat Washers (D)

**Prior to Installation:**

1. Turn off vehicle.
2. Locate the battery compartment.
3. Remove the ground terminal, then the positive terminal to disconnect the battery cables.
4. Adjust wiring if necessary. Some of the existing wiring may interfere with the mounting location. If necessary, unplug the wiring harnesses for the front lights (these run along the frame tubing) and re-route them. See Figure 1.

Installation:

1. Attach winch to mounting plate using hardware supplied with winch. (Do not attach fairlead.)
2. Position winch and mount on the frame as shown in Figure 1. (Please note that the mount is shown without the winch in place in this image.)
3. Check the position of the mounting plate. It should not pinch or potentially damage wiring harnesses.
4. Attach mount to frame using supplied U-bolts and 1/4" hardware.
5. Attach roller / hawse fairlead.
6. Follow all winch instructions for proper wiring.

Figure 1